



Model: Sigma Top Drive	May 15, 2026
Serial #: See Affected Units	
Product Bulletin # TDS-278 Rev 1	

Sigma Top Drive Brake View Cover Upgrade Kit

Canrig has released an upgraded assembly kit for the Sigma Top Drive Brake Housing View Covers (Canrig P/N: AY26035). This kit includes one hinged maintenance window, gasket and fasteners that allows for easier inspection and maintenance access.

Two kits (AY26035) will need to be ordered to upgrade both the DS and ODS view covers. The new View Covers (DT27314) will replace the old View Covers (DT23683 & DT23684).

Affected Units

Affected Units Top Drives model Sigma serial numbers:

- 1385
- 1388
- 1398
- 1400
- 1405
- 1413

To order these kits, contact Canrig TRUE™ Part Sales truesupport@canrig.com.

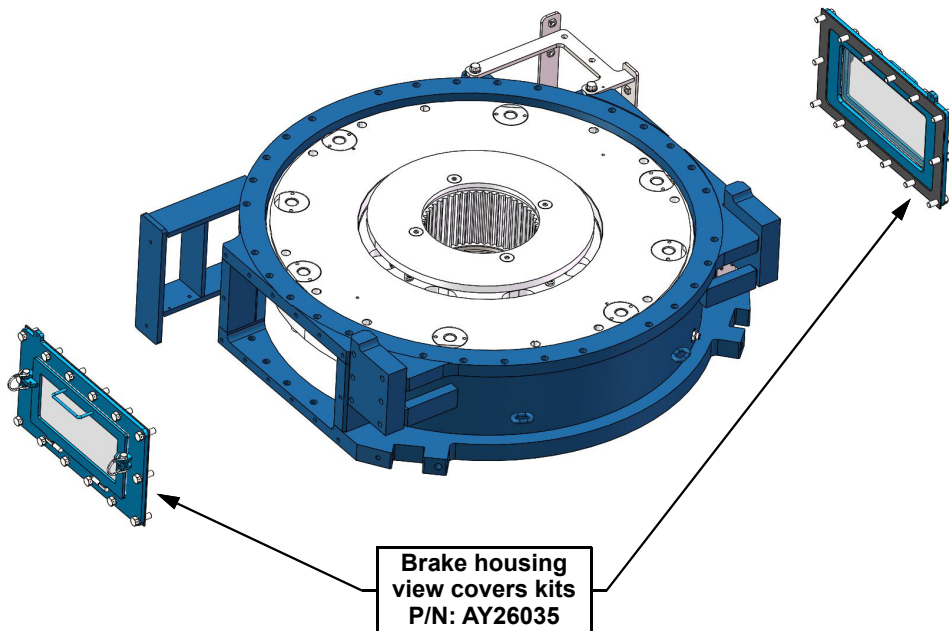

Figure 1: Brake housing view covers kits



Model: Sigma Top Drive
 Serial #: See Affected Units

May 15, 2026

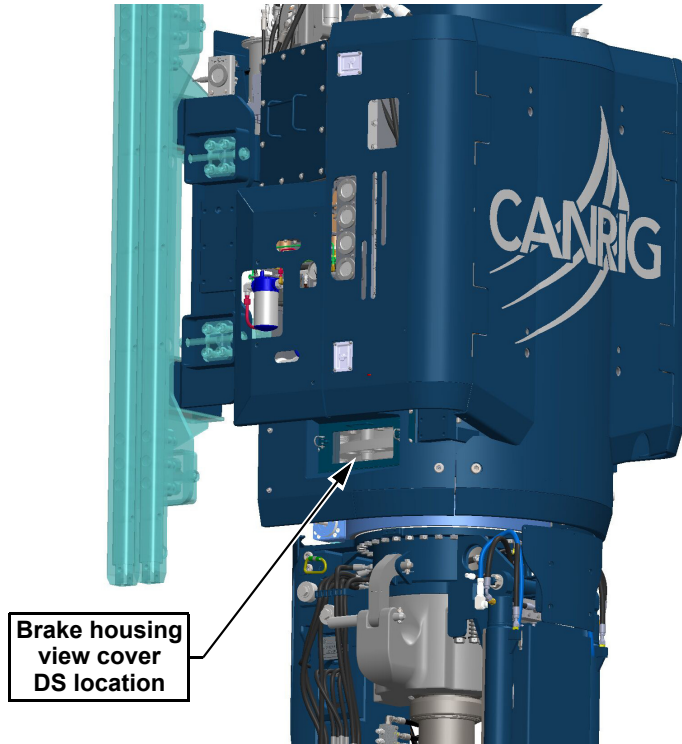

Figure 2: Brake housing view cover DS location

Table 1: AY26035-KIT, VIEW COVER, BRAKE, GUARD, SIGMA

Item	Qty	Units	P/N	Description
1	1	EA	DT27314	VIEW COVER, BRAKE HOUSING, GUARD, SIGMA
2	1	EA	DT23682	GASKET, VIEWCOVER, BRAKE
3	14	PAIR	LW-0500-NL	LOCKWASHER, 1/2 NORD-LOCK
4	14	EA	HH-0500NC-0150-GR8-W	CAPSCR, HEX HD, 1/2-13UNC x 1.50, GR8, W
5	2	EA	M15936	CLEVIS PIN, WIRELOCK 3/8 X 1 1/8
6	2	FT	M10022	WIRE ROPE, 1/8, 7 X 19, STAINLESS
7	4	EA	M19-3009-010	FERRULE, 1/8, OVAL, ALUMINUM
R01	4	EA	M19-3006-010	FERRULE, 1/16, OVAL, ALUMINUM
R02	7	FT	M21-2000-010	WIRE ROPE, 1/16" DIA



Model: Sigma Top Drive
Serial #: See Affected Units

May 15, 2026

Installation Instructions

Refer to Table 1 on page 2 for items indicated below.

1. On the top drive DS, install view cover (item 1) and gasket (item 2) using fourteen (14) capscrews (item 4) and lock washers (item 3) as shown in Figure 3.
2. Torque 14X capscrews (item 4) to value specified in Canrig Specification ENG 725.
3. Apply 1/16" safety wire (items R01 and R02) to all capscrews (item 4) as specified in Canrig Specification ENG 701.

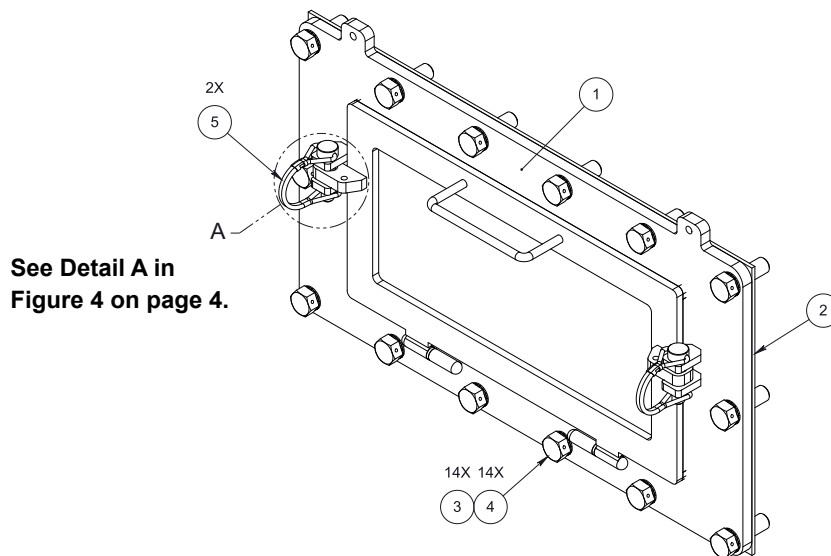

Figure 3: View cover with fasteners



Model: Sigma Top Drive Serial #: See Affected Units
--

May 15, 2026

4. Install 1/8" safety wire and ferrules (Items 6 and 7) between Item 1 and Item 5, as shown in Figure 4. Ensure sufficient slack is provided to allow installation and removal of the clevis pin (Item 5). Perform this procedure in accordance with Canrig Specification ENG 701.

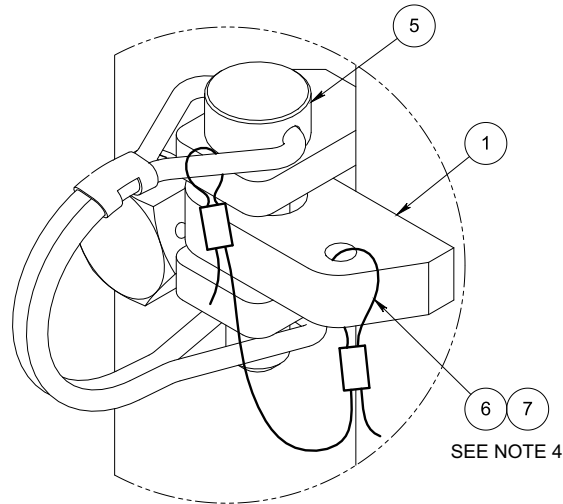

DETAIL A

Figure 4: View cover detail

5. Repeat Step 4 for the other side of the view cover.
6. Repeat Steps 1 through 5 for top drive ODS view cover.

Contact Rigline 24/7™ or your Canrig representative for additional assistance.